



BUREAU OF FIRE SAFETY

EAST BRUNSWICK FIRE DISTRICTS #1 & #3
680 OLD BRIDGE TURNPIKE
EAST BRUNSWICK, N.J. 08816
TEL: (732) 651-8806
FAX: (732) 257-0960

SMOKE/CO DETECTOR INSPECTION GUIDELINE

SMOKE DETECTORS - A 10-year sealed battery detector or hard-wired detector is required on each level of the house including the basement in the vicinity of the stairs. Detectors are required to be within (10) feet of each bedroom. Smoke detectors mounted on the ceiling should be a minimum of (4) inches from a wall. Detectors mounted on a wall should be no closer than (4) inches to the ceiling, and no more than (12) inches from the ceiling. **If at time of construction or required due to improvements, electric/hard wired detectors must be maintained.**

CARBON MONOXIDE DETECTORS - A Carbon monoxide detector is required within (10) feet of a bedroom if the house has a fuel burning appliance and/or an attached garage. The detector must be mounted in the hallway outside of the bedroom.

HOUSE NUMBERS - Numbers may be placed on curbside mailboxes provided they appear on each side of the mailbox and are at least (2") inches in height. All other numbers must be at least (4") inches in height and must be clearly visible from the street. The numbers must contrast with the colors of the surrounding surfaces.

FIRE EXTINGUISHER – Recommended not required as of February 24, 2025

SMOKE DETECTORS SAVE LIVES!

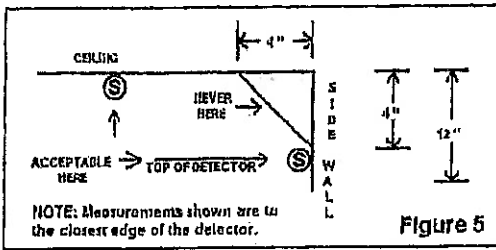
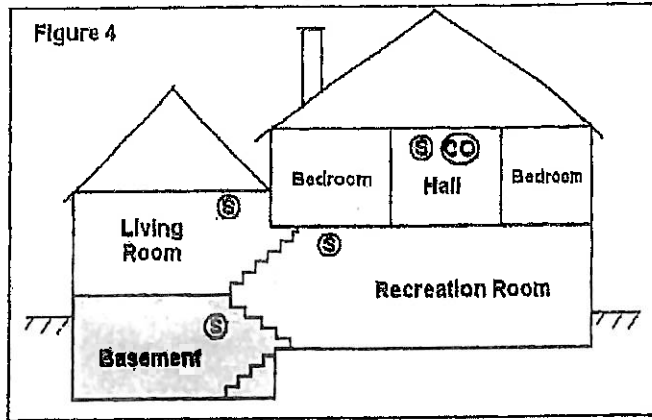
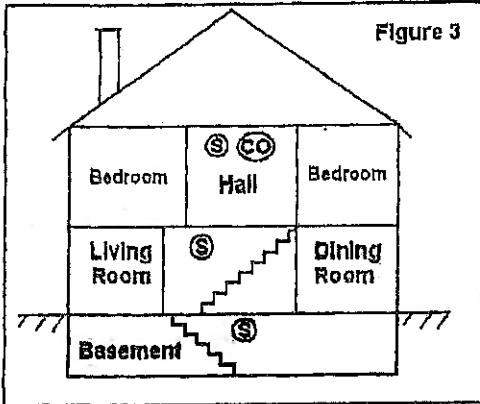
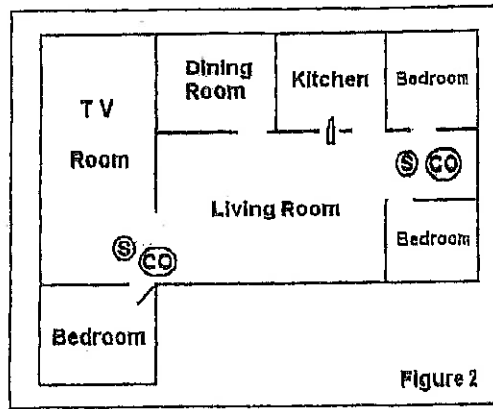
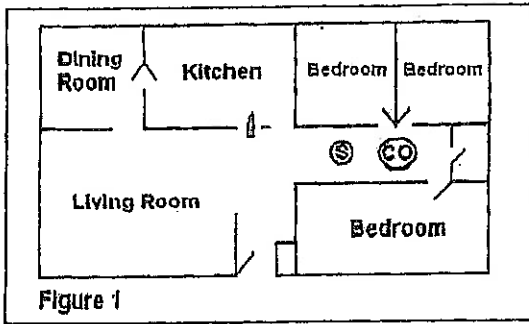

☹ PORTABLE FIRE EXTINGUISHER

Ⓢ SMOKE DETECTOR Ⓢ CARBON MONOXIDE ALARM

SIWFP6-1-001

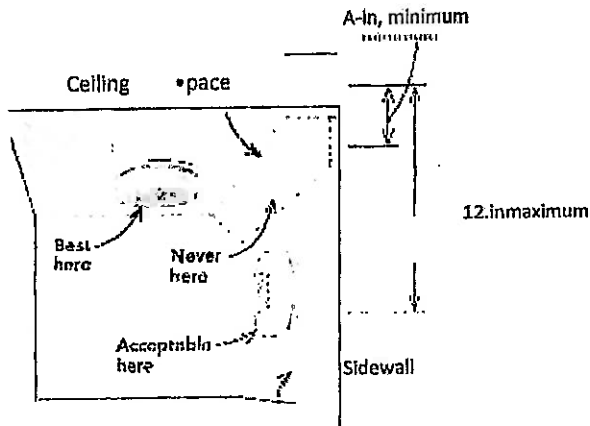

PORTABLE FIRE EXTINGUISHER

